

# UCONN-SOCCER



## 2008 Visiting Team Guide



## Table of Contents

<b>2008 Schedule</b>	<b>2</b>
<b>Visiting Team Information</b>	<b>3</b>
<b>Directions</b>	<b>4</b>
<b>Sports Medicine Information</b>	<b>5</b>
<b>Area Hotels</b>	<b>6</b>
<b>Dining On and Around Campus</b>	<b>7</b>
<b>Transportation Information</b>	<b>8</b>
<b>Entertainment (Movie Theaters / Shopping Malls)</b>	<b>8</b>
<b>Timing Sheet Example</b>	<b>9</b>
<b>Visiting Team Travel Information Form</b>	<b>10</b>
<b>University of Connecticut Storrs Campus Map</b>	<b>11</b>

[UConn Map](#)

Push CTRL + Click on Link

Head Coach: Ray Reid

<b>DATE</b>	<b>OPPONENT/LOCATION</b>	<b>TIME</b>
<b>AUGUST</b>		
16	at Michigan	7:30pm
23	<b>Hofstra</b>	<b>7:00pm</b>
29	<b>St. Peters</b>	<b>7:00pm</b>
31	<b>Tulsa</b>	<b>7:00pm</b>
<b>SEPTEMBER</b>		
3	<b>Stony Brook</b>	<b>7:00pm</b>
6	<b>Boston University</b>	<b>7:00pm</b>
13	at St. Louis	7:00pm
19	<b>Louisville</b>	<b>7:30pm</b>
21	<b>Cincinnati</b>	<b>1:00pm</b>
26	at St. Johns	TBA
28	at Syracuse	TBA
<b>OCTOBER</b>		
3	<b>West Virginia</b>	<b>8:00pm</b>
8	at Providence	TBA
11	at Georgetown	12:00pm
15	<b>Dartmouth</b>	<b>7:00pm</b>
18	at Marquette	7:05pm
22	<b>Yale</b>	<b>7:00pm</b>
25	<b>Notre Dame</b>	<b>7:00pm</b>
28	at Pittsburgh	7:00pm
31	<b>Seton Hall</b>	<b>7:00pm</b>
<b>NOVEMBER</b>		
5	BIG EAST First Round	TBA
8	BIG EAST Quarterfinal	TBA
14	BIG EAST Semifinal (Tamp, FL)	TBA
16	BIG EAST Final (Tampa, FL)	TBA

## Visiting Team Information

<b>Site:</b>	<b>Joseph J. Morrone Stadium</b> – University of Connecticut
<b>Event Manager(s):</b>	Evan Feinglass (860) 486-1258 Christine Clarke (860) 486-0498 Brian Nowak (860) 486-5428
<b>Officials:</b>	As indicated in game contract.
<b>Uniforms:</b>	As the visiting team you will wear your dark colors*. * Unless prior arrangements have been made
<b>Arrival:</b>	A University of Connecticut host will meet your team in front of the Mark Edward Freitas Ice Forum where you will unload and be led to your locker room.
<b>Parking:</b>	Buses and/or vans will be instructed where to park upon arrival by our parking staff once they have reached Morrone Stadium.
<b>Practice:</b>	If you require a practice time at the University of Connecticut, please contact the Events and Operations office at (860) 486-4712.
<b>Bench:</b>	When facing the press box, the visiting team bench is on the right. UConn staff will equip your bench with water, ice. Only those included in your travel party are allowed on the bench and playing field.
<b>Media:</b>	Coordinated through Betsy Devine (860) 486-1498. This includes credentials, phone lines, television, radio and post-game procedures. If necessary, all post-game interviews with players and coaches will take place at midfield.
<b>Medical:</b>	See “Sports Medicine” section of guide.
<b>Locker Room:</b>	Towels supplied upon request (see Visiting Team Info Form).

## **Directions to Joseph J. Morrone Stadium**

### **From Bradley International Airport:**

The University of Connecticut campus is approximately 45 minutes driving time from the airport. Take I-91 south to I-291 east to I-84 east to exit 68. Off the exit take a right on Rte. 195 south and follow signs to the University. Once on campus take a right on North Eagleville Road. At the second stoplight, take a left onto Hillside Road. At the fourth stop sign take a right onto Stadium Road. Joseph J. Morrone Stadium is approximately 1/2 mile on the left.

### **From Hartford:**

The University of Connecticut campus is approximately 30 minutes driving time from the city of Hartford. Take I-84 east to exit 68. Off the exit take a right onto Rte. 195 south and follow signs to the University (just about 8 miles). Once on campus take a right onto North Eagleville Road. At the second stoplight, take a left onto Hillside Road. At the fourth stop sign take a right onto Stadium Road. Joseph J. Morrone Stadium is approximately 1/2 mile on the left.

### **From Boston:**

The University of Connecticut campus is approximately one and one half-hour from Boston. From the Mass Pike, take I-84 west to exit 68. Off the exit take a left on Rte. 195 south and follow signs to the University. Once on campus take a right onto North Eagleville Road. At the second stoplight, take a left onto Hillside Road. At the fourth stop sign take a right onto Stadium Road. Joseph J. Morrone Stadium is approximately 1/2 mile on the left.

### **From Providence:**

The University of Connecticut is approximately one and one quarter hour from Providence. From Rte. 295 take exit 5-6, following signs to Hartford. Take Rte. 6 west to Rte. 101 west to Rte. 44 west. Take a left onto Rte. 195 south. Once on campus take a right onto North Eagleville Road. At the second stoplight take a left onto Hillside Road. At the fourth stop sign take a right onto Stadium Road. Joseph J. Morrone Stadium is approximately 1/2 mile on the left.

### **From New York:**

The University of Connecticut is approximately one and one-half to two hours from New York. Take 95 north to 91 north to 84 east. From 84 east take exit 68. Once off the exit take a right onto Rte. 195 south and follow signs to the University (approx. 7 miles). At the first stoplight (once on campus), take a right onto North Eagleville Road. At the second stoplight, take a left onto Hillside Road. At the fourth stop sign take a right onto Stadium Road. Joseph J. Morrone Stadium is approximately 1/2 mile on the left.

## Sports Medicine and Athletic Training

<b>Director of Sports Medicine:</b>	Dr. Jeff Anderson, MD	860/486-0404
<b>Team Physician:</b>	Dr. Tom Trojian, MD	860/486-0404
<b>Sports Medicine Fellow:</b>	Dr. Stephanie Chu, MD Dr. Timothy Lishnak, MD	860/486-0404 860/486-0404
<b>Team Optometrist:</b>	Dr. James Boccuzzi, OD	860/779-1588
<b>Team Dentist:</b>	Dr. James Raynor, DDS	860/429-6406
<b>Orthopedic Consultants:</b>	Dr. Robert Arciero, MD Dr. Michael Joyce, MD Dr. Augustus Mazzocca, MD Dr. Barry Messinger, MD	*Please contact Main Office 860/486-0404

**Sports Medicine Main Office & Fax Number:** (O)860/486-0404  
(F)860/486-5277

### **Athletic Training Staff:**

Bob Howard, MA, ATC Dept. Head / Football	860/486-3634	Philip Young, ATC Football, Golf	860/486-6353
Philip Young, ATC Football, Golf	860/486-6353	Ralph Mansell, M.Ed., ATC Men's Ice Hockey / M & W Tennis	860/486-3046
Catie Dann, MS, ATC Women's Soccer, Swimming/Diving	860/486-8861	Melissa Marcinick, ATC Volleyball, Softball	860/486-2030
James Doran, MS, ATC Men's Basketball	860/486-0481	Roberto Ruiz, ATC Baseball	860/486-2030
Danielle Pinkus, ATC Field Hockey, Lacrosse	860/486-2030	Mario Diaz, MS, ATC Men's Soccer, Women's Rowing	860/486-2030
Brian Gallagher, MA, ATC Football	860/486-1132	Rosemary Ragle, MS, ATC Women's Basketball	860/486-4641
Patti Kula, MS, ATC Cross Country, Track, Field Hockey	860/486-0480	Ed Blair, ATC Track and Field, Football	860/486-2030

**Training Room Phone Numbers:** Gampel Pavilion: 860/486-0481  
Field House: 860/486-2030

**Area Hospitals:** Campus Ambulance 911  
Campus Informatory 860/486-4700  
Windham Memorial 860/456-9116  
Manchester Memorial 860/646-1222  
St. Francis Hospital, Hartford 860/714-4000

**Sideline Supplies:** Ice, Water, Stretcher, Cups, Splints

**Competition at Storrs:** Training room will open approx. One and a half hours prior to competition. (Sooner by arrangement)

## Hotels of Eastern Connecticut and the Hartford Area

### On Campus

#### **Nathan Hale Inn, Storrs**

855 Bolton Road  
Storrs, CT 06268  
860-427-7888

### Off Campus (15-25 min)

#### **Holiday Inn Express, Vernon**

346 Kelly Rd.  
Vernon, CT 06066  
860-648-2000

#### **Clarion Suites Inn, Manchester**

191 Spencer St.  
Manchester, CT 06042  
860-643-5811

#### **Courtyard Marriott, Manchester**

225 Slater St  
Manchester, CT 06042  
860-533-8484

#### **Extended Stay America, Manchester**

340 Tolland TPK  
Manchester, CT 06042  
860-643-5140

#### **Marriott Residence Inn, Manchester**

201 Hale Rd  
Manchester, CT 06042  
860-432-4242

#### **Hampton Inn and Suites, Manchester**

1432 Pleasant Valley Rd.  
Manchester, CT 06042  
860-644-1732

### Off Campus (30+ mins)

#### **Sheraton Hotel, East Hartford**

100 E River Dr  
East Hartford, CT 06108  
860-528-9703

#### **Crowne Plaza, Hartford**

50 Morgan St.  
Hartford, CT 06120  
860-549-2400

#### **Hilton Garden Inn, Hartford/Glastonbury**

85 Glastonbury Blvd.  
Glastonbury, CT 06033  
860-659-1025

#### **Homewood Suites, Glastonbury**

65 Glastonbury Blvd.  
Glastonbury, CT 06033  
652-8111

#### **Goodwin Hotel, Hartford**

1 Haynes St  
Hartford, CT 06103  
246-7500

#### **Hartford Hilton, Hartford**

315 Trumbull St  
Hartford, CT 06103  
728-5151

#### **Hartford/Windsor Marriott, Windsor**

28 Day Hill Road  
Windsor, CT 06095  
688-7500

#### **Marriott Hotel, Rocky Hill**

100 Capitol Blvd  
Rocky Hill, CT 06067  
257-6000

#### **Crowne Plaza, Cromwell**

100 Berlin Rd. (RT 372)  
Cromwell, CT 06416  
635-2000

#### **Marriott Hotel, Farmington**

15 Farm Springs Rd  
Farmington, CT 06032  
678-1000

#### **Sheraton Hotel, Bradley Airport**

1 Bradley Intl Airport  
Windsor Locks, CT 06096  
(877) 422-5311

## Dining In and Around The Storrs Area

### **Angellino's Italian Eatery**

860-450-7071  
10 min. from campus

### **Applebee's**

860-423-6069  
15 min. from campus

### **Bidwell Tavern**

860-742-6978  
10 min. from campus

### **Blimpies Subs and Salads**

427-7521  
Student Union on campus

### **Chuck & Augie's**

860-486-5633  
Student Union on campus

### **Chuck's / Margaritas**

860-429-1900  
10 min. from campus

### **Domino's Pizza**

429-7969  
On campus

### **Dunkin Donuts**

429-5998  
On campus

### **Fireside Rotisserie**

429-4206  
Student Union on campus

### **Friendly's**

860-429-9427  
2 min. from campus

### **Husky Pizza**

429-6001  
Just off campus

### **Kathy John's**

860-429-0362  
5 min. from campus

### **Panda Express**

427-7515  
Student Union on campus

### **Pompeii Oven**

429-4206  
Student Union on campus

### **Red Rock Cafe**

860-429-1366  
5 min from campus

### **Rein's Deli**

874-1344  
20 min. from campus

### **Sgt. Pepperoni's**

429-8888  
On campus

### **Starbucks**

426-1117  
Just off campus

### **Subway-Storrs**

429-6806  
On Campus

### **Ted's Grinders**

429-9545  
On campus

### **The Good Earth**

429-4206  
Student Union on campus

### **Tostada Grill**

429-4206  
Student Union on campus

### **Wendy's**

427-7512  
Student Union on campus

### **Willington Pizza**

860-429-7433  
10 min. from campus

### **Wings Over Storrs**

429-9464  
Just off campus

## Transportation Information

### Car/Van Rental

(\*\*located in Bradley International Airport)



800-GO-ALAMO\*\*



800-331-1212 \*\*



800-527-0700 \*\*



800-800-4000



800-325-8007



800-654-3131 \*\*



800-CAR-RENT \*\*



800-367-2277

### Bus Companies

**Ambassador:** 860/633-7300

**Constitution Coach:** 800/447-3287

**Post Road Stages:** 800/848-0223

**Arrow Line:** 800/842-8747

**DattCo:** 800/229-4879

## Movie Theatres

**Student Union Theatre** (Student Union on campus) (860) 486-1140

**Mansfield Movieplex 8** (15 min. from campus) (860) 450-0938

**Showcase Cinema - Buckland Hills** (20 min. from campus) (860) 456-9800

## Shopping Malls

### **Buckland Hills Mall**

860/644-6369

Exit 62 off I-84

Exit 5 off 291

20 min. from campus

### **Eastbrook Mall**

860/456-3066

95 Storrs Rd., Mansfield

15 min. from campus

### **West Farms Mall**

860/561-3024

Exit 40 off I-84 West

50 min from campus

# CONNECTICUT MENS SOCCER

## Timing Sheet



## UCONN vs. SETON HALL

October 31, 2008

7:00pm

Joseph J. Morrone Stadium

<u>Clock</u>	<u>T.O.D.</u>	<u>Event</u>
60:00	6:00 pm	Teams may begin warm-up
20:00	6:40 pm	Captains and officials meet
15:00	6:45 pm	Game Rosters submitted and exchanged
10:00	6:50 pm	Horn will sound, teams to clear the field PA's and Welcome
8:00	6:52 pm	Introductions "FIFA" Style 1. Visiting Team Starters (all to midfield, in front of bench) and head coach. 2. Home Team Starters (all to midfield, in front of bench) and head coach. 3. National Anthem
	7:00 pm	Game begins

---

Halftime: 15 minutes

## VISITING TEAM TRAVEL FORM

1. Team Name/Sport \_\_\_\_\_ Date of Game \_\_\_\_\_
2. Travel Coordinator \_\_\_\_\_
- Name of Contact \_\_\_\_\_ Office Phone # \_\_\_\_\_  
Cell Phone # \_\_\_\_\_
- Email address \_\_\_\_\_ Fax # \_\_\_\_\_
3. Mode of Transportation \_\_\_\_\_ # of Buses/Vans \_\_\_\_\_
- Airline \_\_\_\_\_ Date/Time of Arrival \_\_\_\_\_
- Ground Transportation \_\_\_\_\_ Date/Time of Arrival \_\_\_\_\_
4. Hotel Name \_\_\_\_\_ Phone # \_\_\_\_\_
5. Practice Request (Please indicate dates and times)
- Day before game \_\_\_\_\_
- Day of game \_\_\_\_\_

***\*\*Please contact the Operations office at 860/486-4712 to arrange/confirm practice times***

6. Athletic Training
- Name of Contact \_\_\_\_\_ Phone # \_\_\_\_\_
- Email address \_\_\_\_\_

Will you need water/ice for your practice?  YES  NO

***\*\*Water/ice will be set up on the benches for your game***

7. Equipment
- Towels for shower?  YES  NO How many? \_\_\_\_\_
- Will laundry service be required?  YES  NO \_\_\_\_\_
- Name of Contact \_\_\_\_\_ Phone # \_\_\_\_\_
- Email address \_\_\_\_\_

**PLEASE COMPLETE THIS FORM AND EMAIL IT TO [AthleticOperations@uconn.edu](mailto:AthleticOperations@uconn.edu)  
OR FAX IT TO 860/486-5511. THANK YOU.**

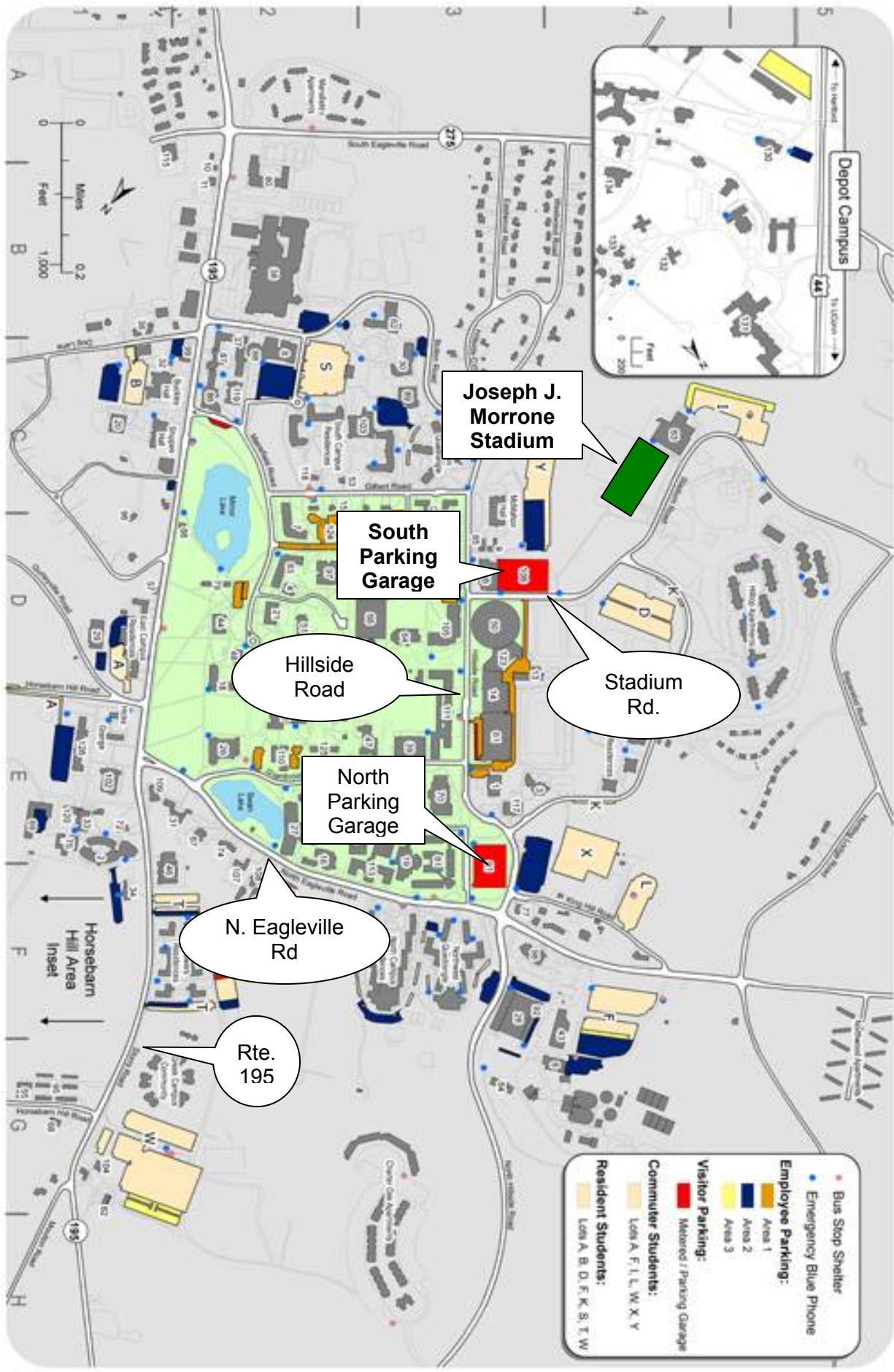

Joseph J. Morrone Stadium

South Parking Garage

Hillside Road

Stadium Rd.

North Parking Garage

N. Eagleville Rd

Rte. 195

- Bus Stop Shelter
- Emergency Blue Phone
- Employee Parking:**
  - Area 1
  - Area 2
  - Area 3
- Visitor Parking:**
  - Marked / Parking Garage
- Commuter Students:**
  - Lots A, F, I, L, W, X, Y
- Resident Students:**
  - Lots A, B, D, F, K, S, T, W