

UConn[®]-VOLLEYBALL



2008 Visiting Team Guide

Table of Contents

2008 Schedule	2
Visiting Team Information	3
Directions	4
Sports Medicine Information	5
Area Hotels	6
Dining On and Around Campus	7
Transportation Information	8
Entertainment (Movie Theaters / Shopping Malls)	8
Timing Sheet Example	9
Visiting Team Travel Information Form	10
University of Connecticut Storrs Campus Map	11

[UConn Map](#)

Push CTRL + Click on Link

WOMEN'S VOLLEYBALL

2008 Women's Volleyball Schedule

Head Coach: Holly Strauss

DATE	OPPONENT/LOCATION	TIME
AUGUST		
29	vs. Cleveland State at Northern Illinois	6:00pm
30	vs. Chicago State	12:00pm
30	at Northern Illinois	8:00pm
SEPTEMBER		
5	vs. Wright State at Albany	5:00pm
6	vs. Buffalo at Albany	10:00am
6	at Albany	7:00pm
12	vs. UW Milwaukee at Michigan State	8:00pm
13	vs. Florida A&M at Michigan State	11:00am
13	at Michigan State	7:00pm
17	Fairfield	7:00pm
19	Cornell (Toyota Classic)	7:30pm
20	Maine (Toyota Classic)	12:30pm
20	Temple (Toyota Classic)	7:30pm
26	Louisville	7:00pm
28	Cincinnati	2:00pm
OCTOBER		
3	at Syracuse	7:00pm
5	at Marquette	2:00pm
8	Hartford	7:00pm
12	Rutgers	2:00pm
15	Sacred Heart	7:00pm
18	at St. Johns	2:00pm
19	at Long Island	2:00pm
24	at Pittsburgh	7:00pm
26	at West Virginia	1:00pm
31	Seton Hall	8:00pm
NOVEMBER		
2	Villanova	2:00pm
8	Georgetown	2:00pm
9	South Florida	2:00pm
14	at DePaul	7:00pm
16	at Notre Dame	2:00pm
20-23	BIG EAST TOURNAMENT (Pittsburgh, PA)	TBA
28/29	at Middle Tennessee State/ vs. St. Louis	TBA

Visiting Team Information

Site:	Harry A. Gampel Pavilion – University of Connecticut	
Event Manager(s):	Evan Feinglass	(860) 486-1258
	Christine Clarke	(860) 486-0498
	Brian Nowak	(860) 486-5428
Stadium Facts:	The Women's Volleyball team plays on the main court of the Harry A. Gampel Pavilion. Gampel Pavilion has a seating capacity of 10,160. The Harry A. Gampel Pavilion is equipped with team locker rooms.	
Directions:	Directions to the Harry A. Gampel Pavilion are on the next page	
Officials:	Assigned by Conference assigner Marcia Alterman.	
Uniforms:	As visiting team, you will wear your dark colors. *Other arrangements must be discussed between coaching staff for tournaments, etc.	
Parking:	Vans can park along side of Gampel Pavilion when available, or in the South Parking Garage. Buses can park in the Bus inlet along Stadium Road across from the Harry A. Gampel Pavilion.	
Team Bench:	The visitor's bench is located on the South end of the arena (On the right when looking at the scorer's table.) Your bench will be equipped with water, ice, and towels.	
Media:	Please contact Kristen Altieri of Athletic Communications at (860) 486-4707 to acquire phone lines, television, radio and post-game procedures.	
Locker rooms:	The visiting team locker room is located in Gampel Pavilion. A host will greet the team upon arrival and escort to the locker room.	

Directions to the Harry A. Gampel Pavilion

From Bradley International Airport:

The University of Connecticut campus is approximately 45 minutes driving time from the airport. Take I-91 South to I-291 East to I-84 East to exit 68. Off the exit take a right on Rte. 195 South and follow signs to the University. Once on campus take a right on North Eagleville Road. At the second stoplight, take a left onto Hillside Road. At the second stoplight, take a left onto Hillside Road. At the third stop sign take a right onto Stadium Road. Harry A. Gampel Pavilion is on your right.

From Hartford:

The University of Connecticut campus is approximately 30 minutes driving time from the city of Hartford. Take I-84 East to exit 68. Off the exit take a right onto Rte. 195 South and follow signs to the University (just about 8 miles). Once on campus take a right onto North Eagleville Road. At the second stoplight, take a left onto Hillside Road. At the second stoplight, take a left onto Hillside Road. At the third stop sign take a right onto Stadium Road. Harry A. Gampel Pavilion is on your right.

From Boston:

The University of Connecticut campus is approximately 1.5 hours from Boston. From the Mass Pike, take I-84 West to exit 68. Off the exit take a left on Rte. 195 South and follow signs to the University. Once on campus take a right onto North Eagleville Road. At the second stoplight, take a left onto Hillside Road. At the third stop sign take a right onto Stadium Road. Harry A. Gampel Pavilion is on your right.

From Providence:

The University of Connecticut is approximately one and one quarter hour from Providence. From Rte. 295 take exit 5-6, following signs to Hartford. Take Rte. 6 West to Rte. 101 West to Rte. 44 west. Take a left onto Rte. 195 South. Once on campus take a right onto North Eagleville Road. At the second stoplight take a left onto Hillside Road. At the third stop sign take a right onto Stadium Road. Harry A. Gampel Pavilion is on your right.

From New York:

The University of Connecticut is approximately one and one-half to two hours from New York. Take 95 North to 91 North to 84 East. From 84 East take exit 68. Once off the exit take a right onto Rte. 195 south and follow signs to the University (approx. 7 miles). At the first stoplight (once on campus), take a right onto North Eagleville Road. At the second stoplight, take a left onto Hillside Road. At the third stop sign take a right onto Stadium Road. Harry A. Gampel Pavilion is on your right.

Sports Medicine and Athletic Training

Director of Sports Medicine:	Dr. Jeff Anderson, MD	860/486-0404
Team Physician:	Dr. Tom Trojjan, MD	860/486-0404
Sports Medicine Fellow:	Dr. Stephanie Chu, MD Dr. Timothy Lishnak, MD	860/486-0404 860/486-0404
Team Optometrist:	Dr. James Boccuzzi, OD	860/779-1588
Team Dentist:	Dr. James Raynor, DDS	860/429-6406
Orthopedic Consultants:	Dr. Robert Arciero, MD Dr. Michael Joyce, MD Dr. Augustus Mazzocca, MD Dr. Barry Messinger, MD	*Please contact Main Office 860/486-0404

Sports Medicine Main Office & Fax Number: (O)860/486-0404
(F)860/486-5277

Athletic Training Staff:

Bob Howard, MA, ATC Dept. Head / Football	860/486-3634	Philip Young, ATC Football, Golf	860/486-6353
Philip Young, ATC Football, Golf	860/486-6353	Ralph Mansell, M.Ed., ATC Men's Ice Hockey / M & W Tennis	860/486-3046
Catie Dann, MS, ATC Women's Soccer, Swimming/Diving	860/486-8861	Melissa Marcinick, ATC Volleyball, Softball	860/486-2030
James Doran, MS, ATC Men's Basketball	860/486-0481	Roberto Ruiz, ATC Baseball	860/486-2030
Danielle Pinkus, ATC Field Hockey, Lacrosse	860/486-2030	Mario Diaz, MS, ATC Men's Soccer, Women's Rowing	860/486-2030
Brian Gallagher, MA, ATC Football	860/486-1132	Rosemary Ragle, MS, ATC Women's Basketball	860/486-4641
Patti Kula, MS, ATC Cross Country, Track, Field Hockey	860/486-0480	Ed Blair, ATC Track and Field, Football	860/486-2030

Training Room Phone Numbers: Gampel Pavilion: 860/486-0481
Field House: 860/486-2030

Area Hospitals: Campus Ambulance 911
Campus Informatory 860/486-4700
Windham Memorial 860/456-9116
Manchester Memorial 860/646-1222
St. Francis Hospital, Hartford 860/714-4000

Sideline Supplies: Ice, Water, Stretcher, Cups, Splints

Competition at Storrs: Training room will open approx. One and a half hours prior to competition. (Sooner by arrangement)

Hotels of Eastern Connecticut and the Hartford Area

On Campus

Nathan Hale Inn, Storrs

855 Bolton Road
Storrs, CT 06268
860-427-7888

Off Campus (15-25 min)

Holiday Inn Express, Vernon

346 Kelly Rd.
Vernon, CT 06066
860-648-2000

Clarion Suites Inn, Manchester

191 Spencer St.
Manchester, CT 06042
860-643-5811

Courtyard Marriott, Manchester

225 Slater St
Manchester, CT 06042
860-533-8484

Extended Stay America, Manchester

340 Tolland TPK
Manchester, CT 06042
860-643-5140

Marriott Residence Inn, Manchester

201 Hale Rd
Manchester, CT 06042
860-432-4242

Hampton Inn and Suites, Manchester

1432 Pleasant Valley Rd.
Manchester, CT 06042
860-644-1732

Off Campus (30+ mins)

Sheraton Hotel, East Hartford

100 E River Dr
East Hartford, CT 06108
860-528-9703

Crowne Plaza, Hartford

50 Morgan St.
Hartford, CT 06120
860-549-2400

Hilton Garden Inn, Hartford/Glastonbury

85 Glastonbury Blvd.
Glastonbury, CT 06033
860-659-1025

Homewood Suites, Glastonbury

65 Glastonbury Blvd.
Glastonbury, CT 06033
652-8111

Goodwin Hotel, Hartford

1 Haynes St
Hartford, CT 06103
246-7500

Hartford Hilton, Hartford

315 Trumbull St
Hartford, CT 06103
728-5151

Hartford/Windsor Marriott, Windsor

28 Day Hill Road
Windsor, CT 06095
688-7500

Marriott Hotel, Rocky Hill

100 Capitol Blvd
Rocky Hill, CT 06067
257-6000

Crowne Plaza, Cromwell

100 Berlin Rd. (RT 372)
Cromwell, CT 06416
635-2000

Marriott Hotel, Farmington

15 Farm Springs Rd
Farmington, CT 06032
678-1000

Sheraton Hotel, Bradley Airport

1 Bradley Intl Airport
Windsor Locks, CT 06096
(877) 422-5311

Dining In and Around the Storrs Area

Angellino's Italian Eatery

860-450-7071
10 min. from campus

Applebee's

860-423-6069
15 min. from campus

Bidwell Tavern

860-742-6978
10 min. from campus

Blimpies Subs and Salads

427-7521
Student Union on campus

Chuck & Augie's

860-486-5633
Student Union on campus

Chuck's / Margaritas

860-429-1900
10 min. from campus

Domino's Pizza

429-7969
On campus

Dunkin Donuts

429-5998
On campus

Fireside Rotisserie

429-4206
Student Union on campus

Friendly's

860-429-9427
2 min. from campus

Husky Pizza

429-6001
Just off campus

Kathy John's

860-429-0362
5 min. from campus

Panda Express

427-7515
Student Union on campus

Pompeii Oven

429-4206
Student Union on campus

Red Rock Cafe

860-429-1366
5 min from campus

Rein's Deli

874-1344
20 min. from campus

Sgt. Pepperoni's

429-8888
On campus

Starbucks

426-1117
Just off campus

Subway-Storrs

429-6806
On Campus

Ted's Grinders

429-9545
On campus

The Good Earth

429-4206
Student Union on campus

Tostada Grill

429-4206
Student Union on campus

Wendy's

427-7512
Student Union on campus

Willington Pizza

860-429-7433
10 min. from campus

Wings Over Storrs

429-9464
Just off campus

Transportation Information

Car/Van Rental

(**located in Bradley International Airport)



800-GO-ALAMO**



800-331-1212 **



800-527-0700 **



800-800-4000



800-325-8007



800-654-3131 **



800-CAR-RENT **



800-367-2277

Bus Companies

Ambassador: 860/633-7300

Arrow Line: 800/842-8747

Constitution Coach: 800/447-3287

DattCo: 800/229-4879

Post Road Stages: 800/848-0223

Movie Theatres

Student Union Theatre (Student Union on campus) (860) 486-1140

Mansfield Movieplex 8 (15 min. from campus) (860) 450-0938

Showcase Cinema - Buckland Hills (20 min. from campus) (860) 456-9800

Shopping Malls

Buckland Hills Mall

860/644-6369

Exit 62 off I-84

Exit 5 off 291

20 min. from campus

Eastbrook Mall

860/456-3066

95 Storrs Rd., Mansfield

15 min. from campus

West Farms Mall

860/561-3024

Exit 40 off I-84 West

50 min from campus

UCONN[®]-VOLLEYBALL

Timing Sheet



UCONN vs. MARQUETTE

November 3, 2007

2:00pm

Harry A. Gampel Pavilion

<u>Time of Day</u>	<u>Game Clock</u>	
1:00pm	60:00 – 19:00	Court available for shared warm-ups
1:30pm	30:00	Coin toss
1:41 – 1:45pm	19:00 – 15:00	Visiting team court
1:45 – 1:49pm	15:00 – 11:00	Home team court
1:49 – 1:54pm	11:00 – 6:00	Visiting team court
1:54 – 1:59pm	6:00 – 1:00	Home team court
1:59 – 4:00pm	1:00 – 0:00	PA Announcements
2:00pm	0:00	1. Anthem/ 2. Introductions/ Match begins

Intermission: 10 minutes (between games 2 & 1)



VISITING TEAM TRAVEL FORM

1. Team Name/Sport _____	Date of Game _____
2. Travel Coordinator	
Name of Contact _____	Office Phone # _____
	Cell Phone # _____
Email address _____	Fax # _____
3. Mode of Transportation _____ # of Buses/Vans _____	
Airline _____	Date/Time of Arrival _____
Ground Transportation _____	Date/Time of Arrival _____
4. Hotel Name _____	Phone # _____
5. Practice Request (Please indicate dates and times)	
Day before game _____	
Day of game _____	

*****Please contact the Operations office at 860/486-4712 to arrange/confirm practice times***

6. Athletic Training	
Name of Contact _____	Phone # _____
Email address _____	

Will you need water/ice for your practice? YES NO

*****Water/ice will be set up on the benches for your game***

7. Equipment	
Towels for shower? <input type="checkbox"/> YES <input type="checkbox"/> NO	How many? _____
Will laundry service be required? <input type="checkbox"/> YES <input type="checkbox"/> NO	_____
Name of Contact _____	Phone # _____
Email address _____	

PLEASE COMPLETE THIS FORM AND EMAIL IT TO AthleticOperations@uconn.edu
OR FAX IT TO 860/486-5511. THANK YOU.

UCONN[®]ATHLETICS

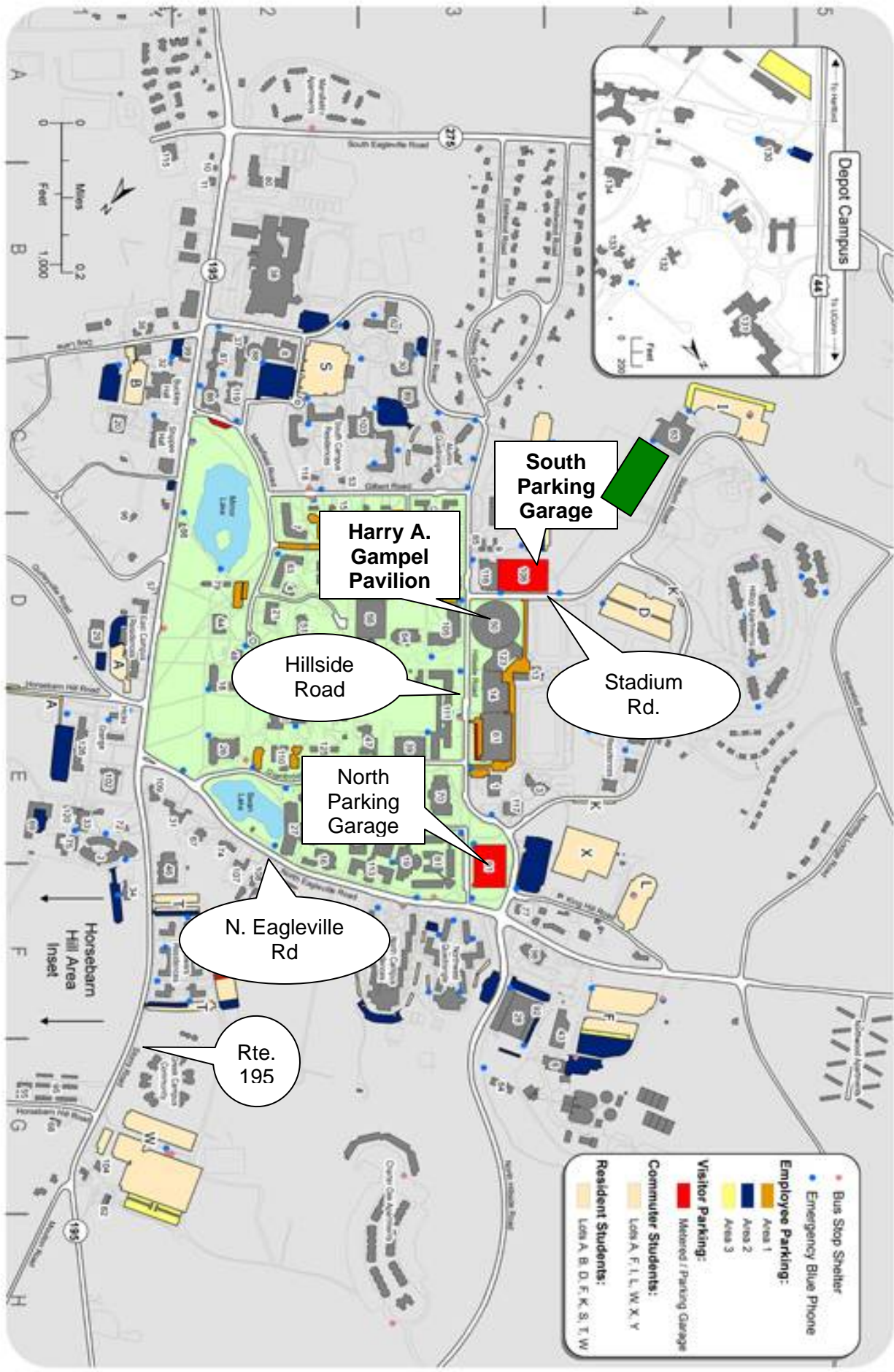

Harry A. Gampel Pavilion

South Parking Garage

Hillside Road

Stadium Rd.

North Parking Garage

N. Eagleville Rd

Rte. 195

- Bus Stop Shelter
- Emergency Blue Phone
- Employee Parking:**
 - Area 1
 - Area 2
 - Area 3
- Visitor Parking:**
 - Marked / Parking Garage
- Commuter Students:**
 - Lots A, F, I, L, W, X, Y
- Resident Students:**
 - Lots A, B, D, F, K, S, T, W